

Customer's Approval

Customer: _____

Date: _____

Pin	Description
1	GND
2	RESET
3	SCL
4	RS
5	CS
6	SDA
7	SDD
8	GND
9	VCC
10	A
11	K1
12	K2
13	K3
14	K4
15	XL
16	YU
17	XR
18	YD

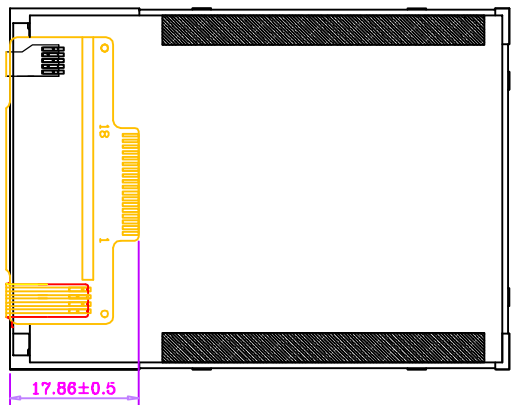
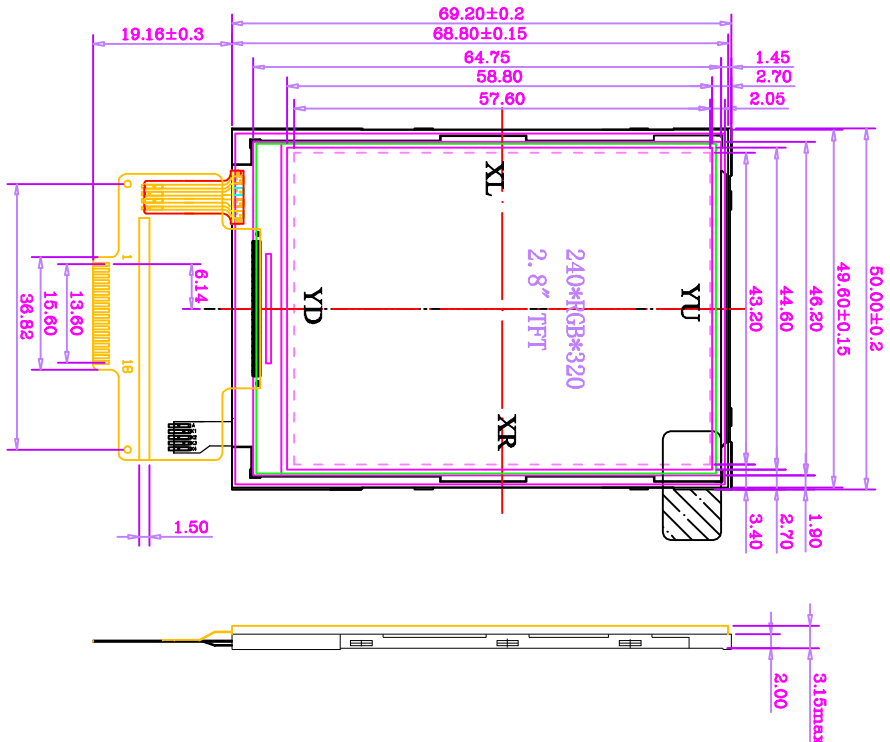

FPC弯折参考
FPC展开出货

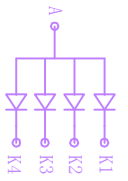

Back Light Circuit

ROHS COMPLIANT

ITEM	ELECTRICAL & PHYSICAL DATA
LCD Type	2.8" TFT
Viewing Direction	120° CLOCK
Drive Method	DTY
VDD	3.3V
Display Mode	Transmissive
Operating Temp	-20° C ~ 70° C
Storage Temp	-30° C ~ 80° C
Connector (LC)	IL19341

SCALE	FREE	TOLERANCE
UNIT	mm	±0.2
MATERIAL		DATE
FINISH		2011/12/08
		DRWN BY
		LIQIUZHU
		DSN BY
		CHECKED BY
		APPROVED BY

PROJECT NO:	
MODULE NO: H40008	
DCN	A4
P I OF I	EDITION
	A

1 2 3 4 5 6 7 8